



# THE DATASHEET OF

## 56



## SURFACE MOUNT BATTERY CLIPS/CONTACTS

AVAILABLE ON TAPE AND REEL

- "Flow-Hole" SMT solder tail design for increased joint strength
- Tin-Nickel plating is ideal for lead free, high temperature soldering
- Matte Tin Plate for lower soldering temperatures ideal where other temperature sensitive components are being used



Refer to page 34 for Battery Contact Layout & Mounting Details



"AAAA" - "A27"

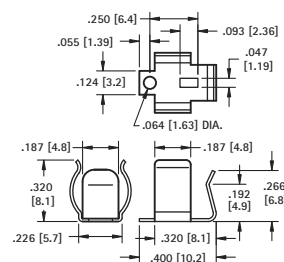

**MATERIAL:** .010 (.25) Spring Steel

TIN-NICKEL PLATE	MATTE TIN PLATE
CAT. NO. ON TAPE BULK & REEL	CAT. NO. ON TAPE BULK & REEL
50 50TR	550 550TR

**Tape & Reel Spec's:** 24mm wide; 16mm pitch; 13 inch reel, (500 pieces per reel)

Pad Layout

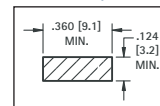

"AAA" - "N" - "A23"

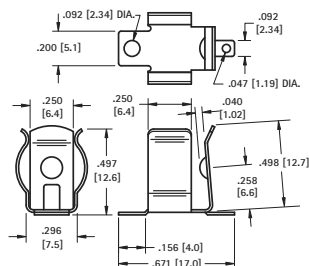

**MATERIAL:** .010 (.25) Spring Steel

TIN-NICKEL PLATE	MATTE TIN PLATE
CAT. NO. ON TAPE BULK & REEL	CAT. NO. ON TAPE BULK & REEL
55 55TR	555 555TR

**Tape & Reel Spec's:** 32mm wide; 16mm pitch; 13 inch reel, (300 pieces per reel)

Pad Layout

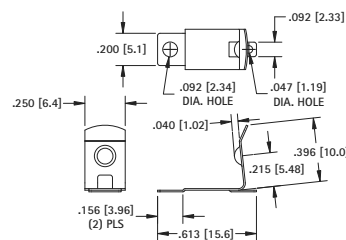
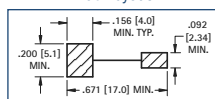

**MATERIAL:** .010 (.25) Spring Steel

TIN-NICKEL PLATE	MATTE TIN PLATE
CAT. NO. ON TAPE BULK & REEL	CAT. NO. ON TAPE BULK & REEL
56 56TR	556 556TR

**Tape & Reel Spec's:** 32mm wide; 20mm pitch; 13 inch reel, (250 pieces per reel)

Pad Layout

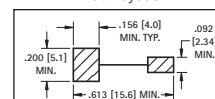

"AA" - "CR2" - "A"

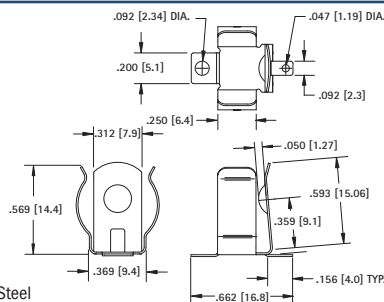

**MATERIAL:** .012 (.30) Spring Steel

TIN-NICKEL PLATE	MATTE TIN PLATE
CAT. NO. ON TAPE BULK & REEL	CAT. NO. ON TAPE BULK & REEL
53 53TR	553 553TR

**Tape & Reel Spec's:** 32mm wide; 24mm pitch; 13 inch reel, (150 pieces per reel)

Pad Layout

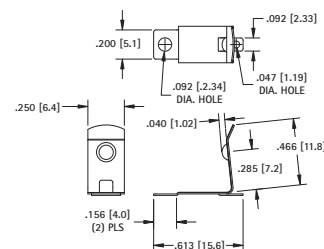
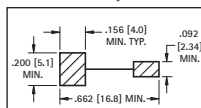

**MATERIAL:** .010 (.25) Spring Steel

TIN-NICKEL PLATE	MATTE TIN PLATE
CAT. NO. ON TAPE BULK & REEL	CAT. NO. ON TAPE BULK & REEL
57 57TR	557 557TR

**Tape & Reel Spec's:** 32mm wide; 20mm pitch; 13 inch reel, (250 pieces per reel)

Pad Layout

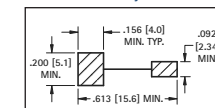

## SURFACE MOUNT LEAF-SPRING CONTACTS

AVAILABLE ON TAPE AND REEL

- Economical & reliable contacts are ideal for surface mount applications
- Unique spring tension contacts adjust to variations in battery length

"AAA" - "AAAA" - "A23" - "N"

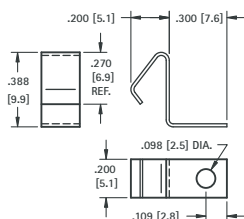

**MATERIAL:** .010 (.25) Spring Steel

TIN-NICKEL PLATE	MATTE TIN PLATE
CAT. NO. ON TAPE BULK & REEL	CAT. NO. ON TAPE BULK & REEL
5230 5230TR	5330 5330TR

**Tape and Reel Spec's:** 24mm wide; 12mm pitch; 13 inch reel (400 pieces per reel)

"AA" - "CR2" - "A" - "9V"

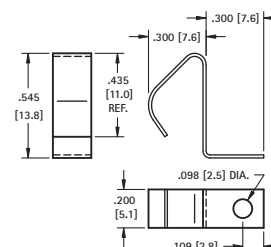

**MATERIAL:** .010 (.25) Spring Steel

TIN-NICKEL PLATE	MATTE TIN PLATE
CAT. NO. ON TAPE BULK & REEL	CAT. NO. ON TAPE BULK & REEL
5231 5231TR	5331 5331TR

**Tape and Reel Spec's:** 32mm wide; 16mm pitch; 13 inch reel (250 pieces per reel)